

**SIMBOLOGÍA PLANTA**

- LÍNEA CENTRAL
- ORILLA DE CARRETERA
- - - CERCO DE POÁS
- CERCO DE MALLA
- MURO
- 45 CURVAS MAYORES
- CURVAS MENORES
- ALCANTARILLA
- CRUCE DE AGUA
- BN (BANCO DE NIVEL)
- PI
- PI
- TROMPO

**PERFIL**

- TERRENO NATURAL
- RASANTE
- SECCIÓN DE ALCANTARILLA
- PI

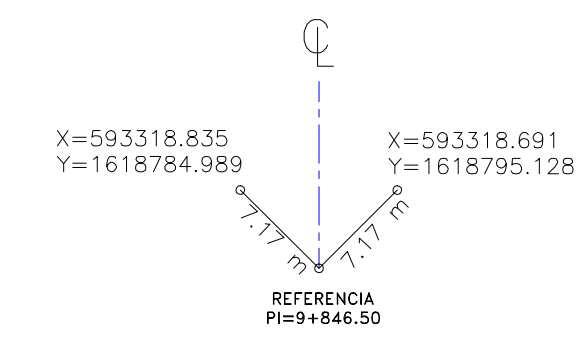

**TERRACERÍA**  
CORTE = 544.51 m<sup>3</sup>  
RELLENO = 29286.69 m<sup>3</sup>  
DE 9+600 A 10+400

**BN# 10-1**  
X=593,519,233  
Y=1,618,714,521  
Z=69,6634  
ESTABLECIDO CLAVO ACERA PUENTE GUAYAPE  
3.90 m LADO IZQUIERDO DE ESTACIÓN 10+056

**CUADRO DE DRENAJE MENOR**

No.	ALC	ESTACIÓN	DIÁMETRO Y TIPO	LONGITUD (m)			PENDIENTE (%)	ELEVACIÓN		SESGO	OBRAS DE ARTE		OBSERVACIONES
				IZQ.	DER.	TOTAL		IZQ	DER		IZQ	DER	
75	9+663.60	42" TCR	14.15	14.20	28.30	0.35	60.338	60.438	90°00'00"	CR	CR		
76	9+669.60	42" TCR	14.15	14.20	28.30	0.35	60.388	60.488	90°00'00"	CR	CR		
77	9+675.60	42" TCR	14.15	14.20	28.30	0.35	60.378	60.478	90°00'00"	CR	CR		
78	9+681.65	42" TCR	14.15	14.20	28.30	0.35	60.358	60.458	90°00'00"	CR	CR		
79	9+687.65	42" TCR	14.15	14.20	28.30	0.35	60.358	60.458	90°00'00"	CR	CR		
80	9+693.65	42" TCR	14.15	14.20	28.30	0.35	60.358	60.458	90°00'00"	CR	CR		
81	9+699.75	42" TCR	14.15	14.20	28.30	0.35	60.358	60.458	90°00'00"	CR	CR		
82	9+705.65	42" TCR	14.15	14.20	28.30	0.35	60.408	60.508	90°00'00"	CR	CR		
83	9+711.65	42" TCR	14.15	14.20	28.30	0.35	60.378	60.478	90°00'00"	CR	CR		
84	9+717.65	42" TCR	14.15	14.20	28.30	0.35	60.378	60.478	90°00'00"	CR	CR		
85	9+723.65	42" TCR	14.15	14.20	28.30	0.35	60.098	60.198	90°00'00"	CR	CR		
86	9+729.65	42" TCR	14.15	14.20	28.30	0.35	60.098	60.198	90°00'00"	CR	CR		
87	9+735.65	42" TCR	14.15	14.20	28.30	0.35	60.098	60.198	90°00'00"	CR	CR		
88	9+741.65	42" TCR	14.15	14.20	28.30	0.35	60.098	60.198	90°00'00"	CR	CR		
89	9+747.65	42" TCR	14.15	14.20	28.30	0.35	60.098	60.198	90°00'00"	CR	CR		
90	9+753.65	42" TCR	14.15	14.20	28.30	0.35	60.098	60.198	90°00'00"	CR	CR		
91	9+759.65	42" TCR	14.15	14.20	28.30	0.35	60.098	60.198	90°00'00"	CR	CR		
92	9+765.65	42" TCR	14.15	14.20	28.30	0.35	60.098	60.198	90°00'00"	CR	CR		
93	9+771.65	42" TCR	14.15	14.20	28.30	0.35	60.098	60.198	90°00'00"	CR	CR		
94	9+777.65	42" TCR	14.15	14.20	28.30	0.35	60.098	60.198	90°00'00"	CR	CR		
95	9+783.65	42" TCR	14.15	14.20	28.30	0.35	60.098	60.198	90°00'00"	CR	CR		
96	9+789.65	42" TCR	14.15	14.20	28.30	0.35	60.098	60.198	90°00'00"	CR	CR		
97	9+795.65	42" TCR	14.15	14.20	28.30	0.35	60.098	60.198	90°00'00"	CR	CR		
98	9+801.70	42" TCR	14.15	14.20	28.30	0.35	60.098	60.198	90°00'00"	CR	CR		
99	9+807.65	42" TCR	14.15	14.20	28.30	0.46	60.068	60.198	90°00'00"	CR	CR		

NOTAS:  
CR=CABEZAL  
SO=SIN OBRA  
CA=CABEZAL CON ALAS  
T=TRAGANTE

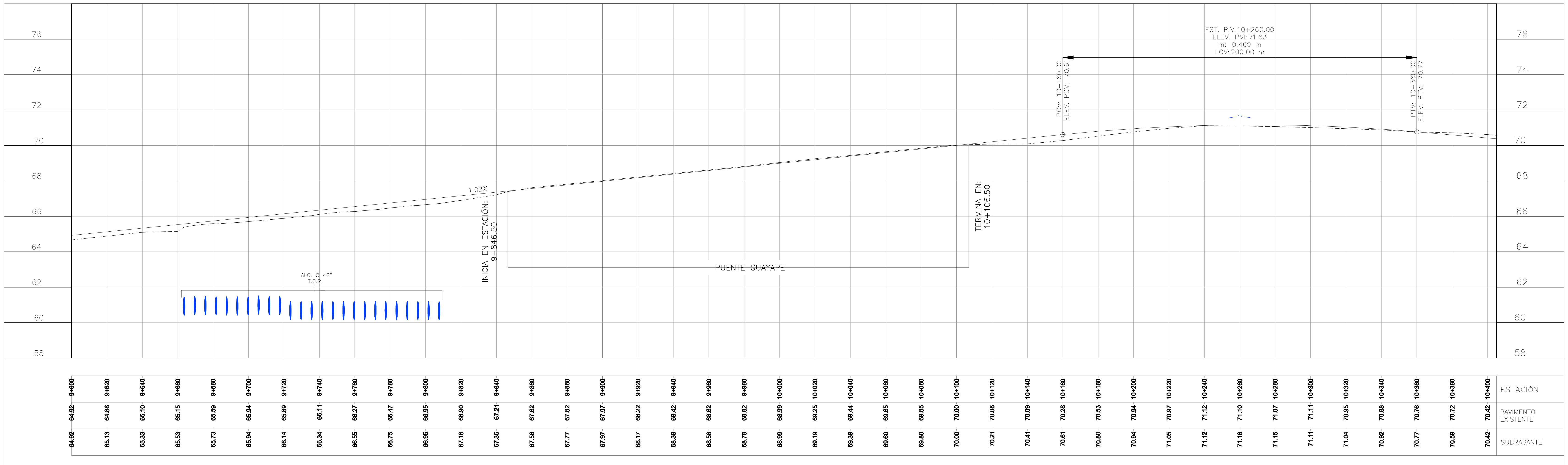
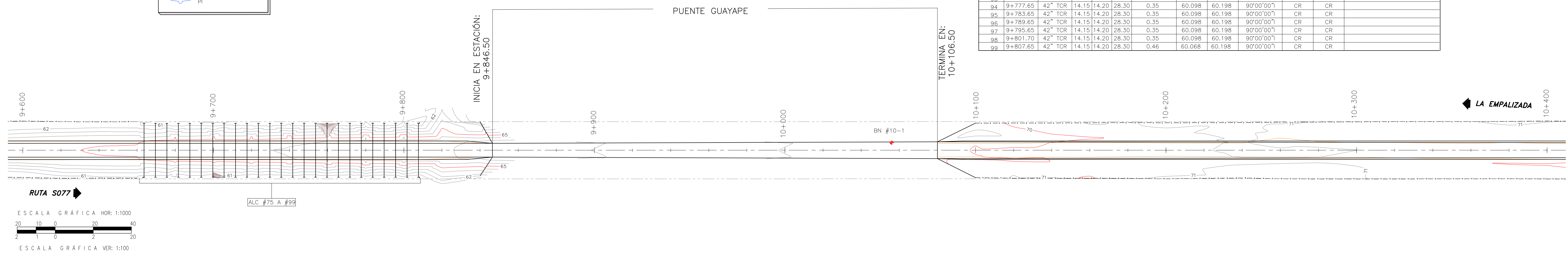

ESTACIÓN	PAVIMENTO EXISTENTE	SUBRASANTE
9+600	64.92	64.92
9+620	64.88	65.13
9+640	65.10	65.33
9+660	65.15	65.53
9+680	65.59	65.73
9+700	65.94	65.94
9+720	65.89	66.14
9+740	66.11	66.34
9+760	66.27	66.55
9+780	66.47	66.75
9+800	66.95	66.95
9+820	66.90	67.16
9+840	67.21	67.36
9+860	67.62	67.56
9+880	67.82	67.77
9+900	67.97	67.97
9+920	68.22	68.17
9+940	68.42	68.38
9+960	68.62	68.58
9+980	68.82	68.78
10+000	68.99	68.99
10+020	69.25	69.19
10+040	69.44	69.39
10+060	69.65	69.60
10+080	69.85	69.80
10+100	70.00	70.00
10+120	70.08	70.21
10+140	70.09	70.41
10+160	70.28	70.61
10+180	70.53	70.80
10+200	70.94	70.94
10+220	70.97	71.05
10+240	71.12	71.12
10+260	71.10	71.16
10+280	71.07	71.15
10+300	71.11	71.11
10+320	70.95	71.04
10+340	70.88	70.92
10+360	70.78	70.77
10+380	70.72	70.59
10+400	70.42	70.42